

WILLIAM P. ANKELE, JR.
JENNIFER GRUBER TANAKA
CLINT C. WALDRON
KRISTIN BOWERS TOMPKINS
ROBERT G. ROGERS
BLAIR M. DICKHONER
GEORGE M. ROWLEY



OF COUNSEL:
KRISTEN D. BEAR
K. SEAN ALLEN
TRISHA K. HARRIS
ZACHARY P. WHITE
HEATHER L. HARTUNG
MEGAN J. MURPHY

EVE M. G. VELASCO
AUDREY G. JOHNSON
CAREY S. SMITH V
ERIN K. STUTZ
JON L. WAGNER

December 13, 2021

**VIA ELECTRONIC SUBMISSION
AND ELECTRONIC MAIL**

Division of Local Government
E-filed via www.dola.colorado.gov/e-filing

Jefferson County Clerk and Recorder
100 Jefferson County Parkway
SUITE 2560 Golden, CO 80419
clerktoboard@jeffco.us

Jefferson County Assessor
100 Jefferson County Parkway
Suite 2500
Golden, CO 80419
assessor@jeffco.us

**Re: Conifer Metropolitan District (LGID#:65404)
Map Filing Pursuant to §32-1-306, C.R.S. – No Change in Boundaries**

To Whom It May Concern:

Section 32-1-306, C.R.S., requires special districts to provide a current, accurate map of their boundaries to the Division of Local Government, County Clerk and Recorder and County Assessor by January 1 of each year. This letter is to inform you that the map that is currently on file with your office for the above-referenced District is the most current and accurate map. A copy of the current map is attached for your convenience.

Should you have any questions, please do not hesitate to contact me.

Sincerely,

WHITE BEAR ANKELE TANAKA & WALDRON
Attorneys at Law

Abby J. Franz, Paralegal

Enclosure

Conifer Metropolitan District

WELL COLLECTION LINES

NOTES

1. REFER TO PARTIAL SITE PLAN SHEET 1.
2. PROPOSED WELLS 1 AND 2 TO BE INSTALLED FOR THIS WORK BY OTHERS.
3. FOR NOTES CONCERNING COLLECTION PIPING, SEE SPECIAL CONDITIONS.
4. SEQUENCE OF WORK SHOWN ON SITE MAP BY CROSSING WITH THE PROVISION OF WELL COLLECTION PIPING AND WATER PLANT WORKS.
5. THE 60 VALVES WILL BE REQUIRED IN THE WELL COLLECTION LINE, IN ADDITION TO VALVES INSTALLED AT THE WELLS.

ENGINEER STATEMENT

PREPARED UNDER MY DIRECT SUPERVISION FOR AND ON BEHALF OF
 JR ENGINEERING, LLC

FILES N. REC. N. P.E. #30038 DATE

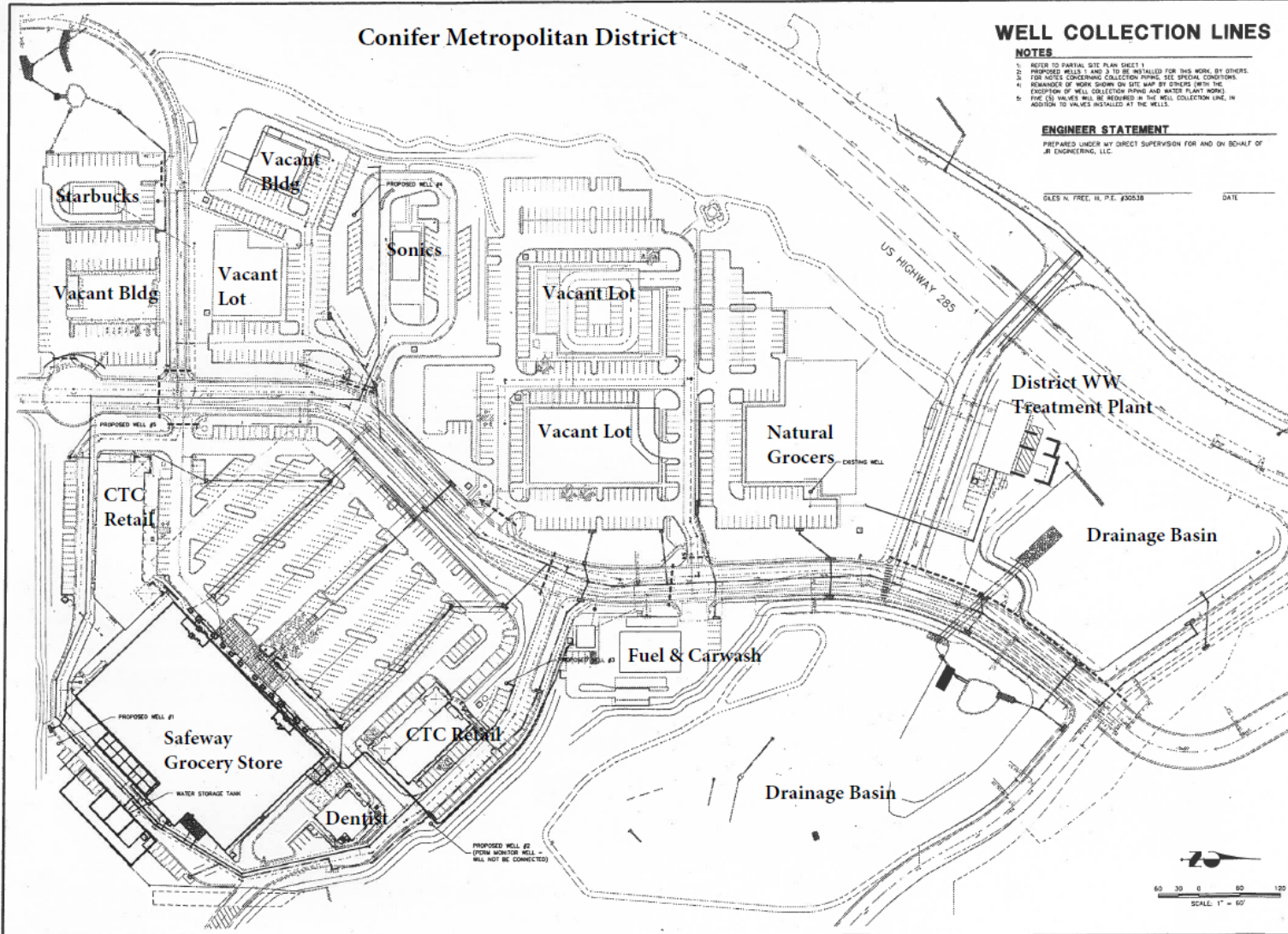

UNLESS SPECIFICALLY NOTED AS APPROVED BY THE ENGINEER, ALL DIMENSIONS, LOCATIONS, AND ELEVATIONS ARE TO BE FIELD VERIFIED BY THE CONTRACTOR. ONLY FOR THE PURPOSES OF AUTOMATICALLY WRITTEN DIMENSIONS.	
CONIFER TOWN CENTER, LLC MANAGING PARTNERS: DAVID B. COPPNER AND ALAN FISHERMAN 10801 WEST TOLLER DRIVE SUITE 100 BOULDER, CO 80501-4430	
JR ENGINEERING A Water Company 6500 Greenwood Plaza Blvd., Englewood, CO 80111 303-440-9800 • Fax: 303-791-9800 jrengineering.com	
BY:	DATE:
REV.	REVISION
H-S SCALE	1" = 60'
V-S SCALE	1" = 60'
DATE	4/14/05
DESIGNED BY	MAC
DRAWN BY	MAC
CHECKED BY	
CONIFER TOWN CENTER WATER PLAN WELL COLLECTION LINES	
SHEET	01 OF 02
JOB NO.	14750.01