

WILLIAM P. ANKELE, JR.  
JENNIFER GRUBER TANAKA  
CLINT C. WALDRON  
KRISTIN BOWERS TOMPKINS  
ROBERT G. ROGERS  
BLAIR M. DICKHONER

OF COUNSEL:  
KRISTEN D. BEAR  
K. SEAN ALLEN  
GEORGE M. ROWLEY



ZACHARY P. WHITE  
TRISHA K. HARRIS  
HEATHER L. HARTUNG  
MEGAN J. MURPHY  
EVE M. G. VELASCO  
ALLISON C. FOGG  
LAURA S. HEINRICH  
AUDREY G. JOHNSON  
LISA CANNON

December 21, 2020

**VIA ELECTRONIC SUBMISSION  
AND ELECTRONIC MAIL**

Division of Local Government  
*E-filed via [www.dola.colorado.gov/e-filing](http://www.dola.colorado.gov/e-filing)*

Jefferson County Clerk and Recorder  
100 Jefferson County Parkway  
Suite 2560  
Golden, CO 80419  
[clerktoboard@jeffco.us](mailto:clerktoboard@jeffco.us)

Jefferson County Assessor  
100 Jefferson County Parkway  
Suite 2500  
Golden, CO 80419  
[assessor@jeffco.us](mailto:assessor@jeffco.us)

**Re: Conifer Metropolitan District (LGID#:65404)  
Map Filing Pursuant to §32-1-306, C.R.S. – No Change in Boundaries**

To Whom It May Concern:

Section 32-1-306, C.R.S., requires special districts to provide a current, accurate map of their boundaries to the Division of Local Government (the “Division”), County Clerk and Recorder and County Assessor by January 1 of each year. This letter is to inform you that the map that is currently on file with your office for the above-referenced District is the most current and accurate map. A copy of the current map is attached for your convenience.

Should you have any questions, please do not hesitate to contact me.

Sincerely,

WHITE BEAR ANKELE TANAKA & WALDRON  
Attorneys at Law

Abby J. Franz, Paralegal

Enclosure

# Conifer Metropolitan District

## WELL COLLECTION LINES

### NOTES

1. REFER TO PARTIAL SITE PLAN SHEET 1.
2. PROPOSED WELLS 1 AND 2 TO BE INSTALLED FOR THIS WORK BY OTHERS.
3. FOR NOTES CONCERNING COLLECTION PIPING, SEE SPECIAL CONDITIONS.
4. REARRANGE OF WORK SHOWN ON SITE MAP BY CHANGES WITH THE EXCEPTION OF WELL COLLECTION PIPING AND WATER PLANT WORKS.
5. THE 60 VALVES WILL BE REQUIRED IN THE WELL COLLECTION LINE, IN ADDITION TO VALVES INSTALLED AT THE WELLS.

### ENGINEER STATEMENT

PREPARED UNDER MY DIRECT SUPERVISION FOR AND ON BEHALF OF  
 JR ENGINEERING, LLC

FILES N. REC. N. P.E. #30038 DATE

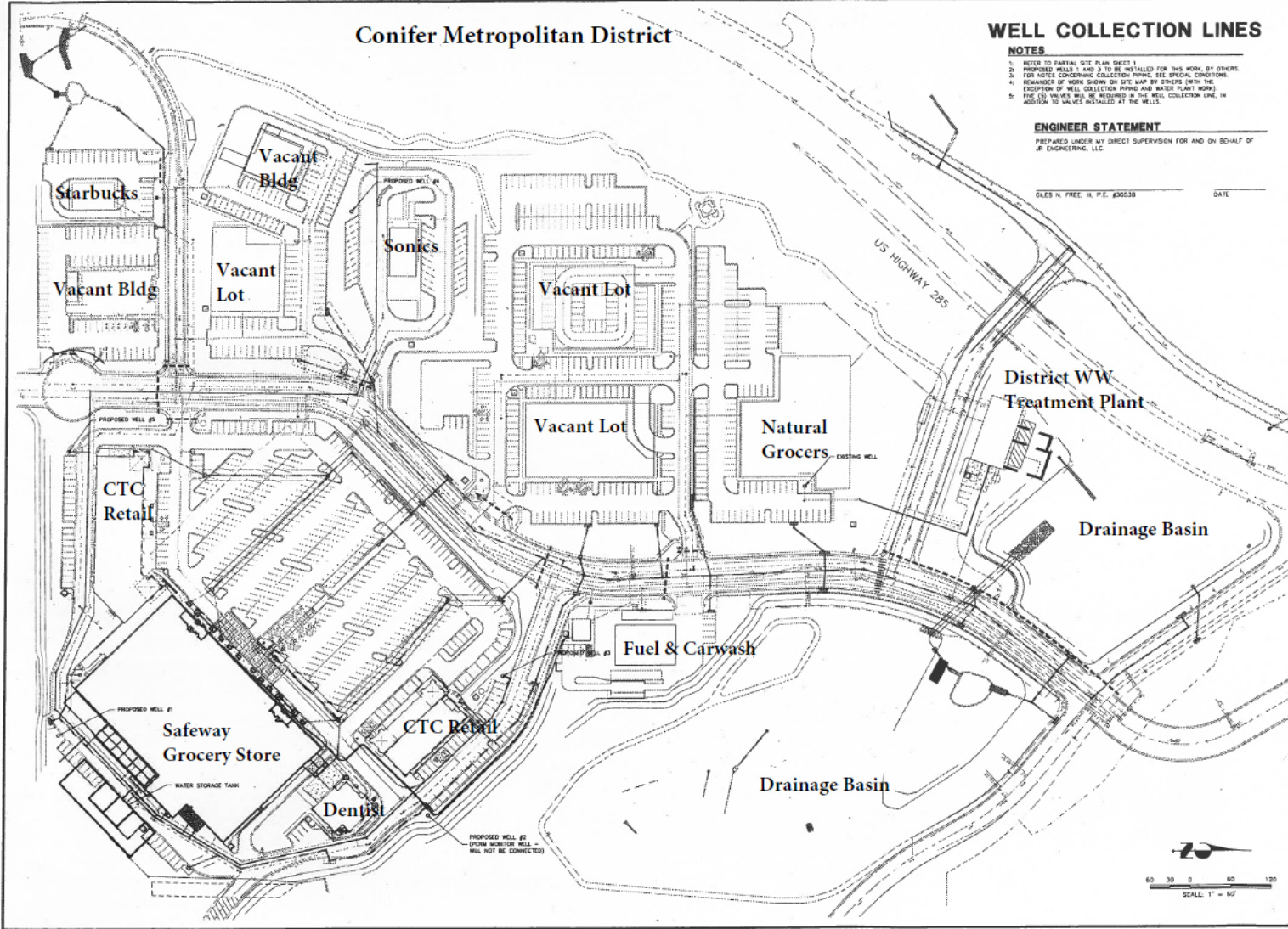

UNLESS SPECIFICALLY NOTED AS APPROVED BY THE ENGINEERING AGENTS, ALL EXISTING CONDITIONS ARE TO REMAIN UNLESS OTHERWISE SPECIFICALLY NOTED IN WRITTEN AUTHORIZATION.	
CONIFER TOWN CENTER, LLC MANAGING ENGINEERS: DAVID B. COPPNER AND ALAN FISHERMAN 10801 WEST TOLLER DRIVE SUITE 100 BOULDER, CO 80501-4430	
<b>JR ENGINEERING</b> A Water Company 6200 Greenwood Plaza Blvd., Englewood, CO 80111 303-660-9800 • Fax: 303-791-9800 jrengineering.com	
BY:	DATE:
REV.	REVISION
H-S SCALE	1" = 60'
V-S SCALE	1" = 60'
DATE	4/14/05
DESIGNED BY	MAC
DRAWN BY	MAC
CHECKED BY	
CONIFER TOWN CENTER WATER PLAN WELL COLLECTION LINES	
SHEET	01 OF 02
JOB NO.	14750-01

