

WILLIAM P. ANKELE, JR.
JENNIFER GRUBER TANAKA
CLINT C. WALDRON
KRISTIN BOWERS TOMPKINS
ROBERT G. ROGERS
BLAIR M. DICKHONER

OF COUNSEL:
KRISTEN D. BEAR
K. SEAN ALLEN
GEORGE M. ROWLEY



ZACHARY P. WHITE
TRISHA K. HARRIS
HEATHER L. HARTUNG
MEGAN J. MURPHY
EVE M. GRINA
ALLISON C. FOGG
JENNIFER C. ROGERS
LAURA S. HEINRICH
AUDREY G. JOHNSON
CHRISTOPHER T. McMICHAEL

December 5, 2019

**VIA ELECTRONIC SUBMISSION
AND ELECTRONIC MAIL**

Division of Local Government
via e-filing portal

Jefferson County Clerk & Recorder
countyclerk@jeffco.us

Jefferson County Assessor
assessor@jeffco.us

**Re: Conifer Metropolitan District (LGID#: 65404)
Map Filing Pursuant to §32-1-306, C.R.S. – No Change in Boundaries**

To Whom It May Concern:

Section 32-1-306, C.R.S., requires special districts to provide a current, accurate map of their boundaries to the Division of Local Government (the “Division”), County Clerk and Recorder and County Assessor by January 1 of each year. This letter is to inform you that the map that is currently on file with your office for the above-referenced District is the most current and accurate map. A copy of the current map is attached for your convenience.

Should you have any questions, please do not hesitate to contact me.

Sincerely,

WHITE BEAR ANKELE TANAKA & WALDRON
Attorneys at Law

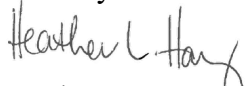
Heather L. Hartung, Esq.

Attachment

Conifer Metropolitan District

WELL COLLECTION LINES

NOTES

1. REFER TO PARTIAL SITE PLAN SHEET 1.
2. PROPOSED WELLS 1 AND 2 TO BE INSTALLED FOR THIS WORK BY OTHERS.
3. FOR NOTES CONCERNING COLLECTION PIPING, SEE SPECIAL CONDITIONS.
4. REVISIONS OF WORK SHOWN ON SITE MAP BY CHANGES WITHIN THE PROVISION OF WELL COLLECTION PIPING AND WATER PLANT WORKS.
5. THE 60 VALVES WILL BE REQUIRED IN THE WELL COLLECTION LINE, IN ADDITION TO VALVES INSTALLED AT THE WELLS.

ENGINEER STATEMENT

PREPARED UNDER MY DIRECT SUPERVISION FOR AND ON BEHALF OF
 JR ENGINEERING, LLC

FILES N. REC. N. P.E. #30038

DATE

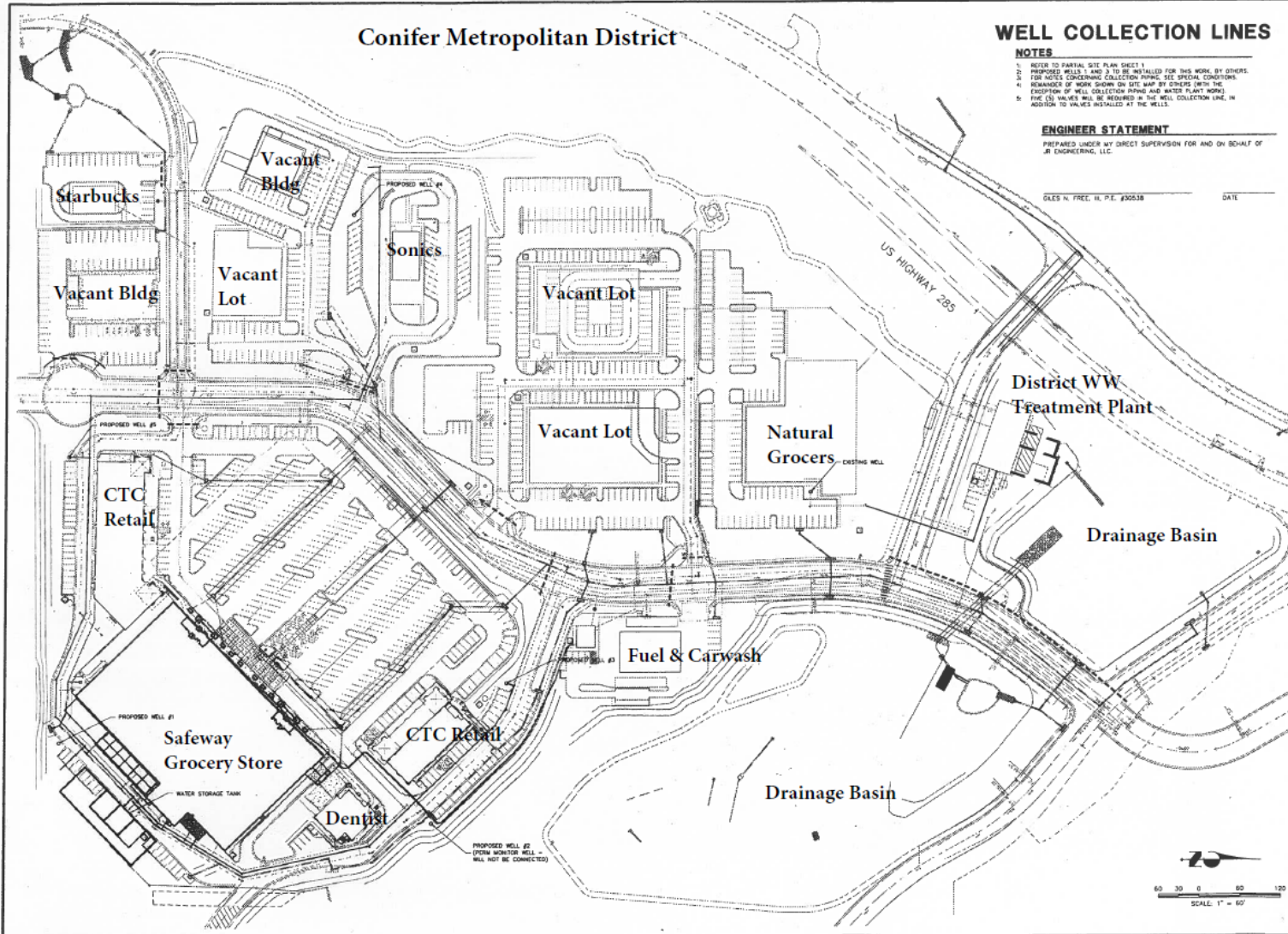

UNITS SUCH AS FEET AND INCHES SHALL BE APPROVED BY THE ENGINEER. ALL DIMENSIONS SHALL BE APPROVED BY THE ENGINEER. ONLY FOR THE PURPOSES OF THIS PLAN. ALL DIMENSIONS SHALL BE APPROVED BY THE ENGINEER.	
CONIFER TOWN CENTER, LLC MANAGING PARTNERS: DAVID B. COPPNER AND ALAN FISHERMAN 10801 WEST TOLLER DRIVE SUITE 100 BOULDER, CO 80501-4430	
JR ENGINEERING A Water Company 6200 Greenwood Plaza Blvd., Englewood, CO 80155 303-680-9800 Fax: 303-791-9800 jrengineering.com	
BY:	DATE:
REV.	REVISION
H-S SCALE	1" = 60'
V-S SCALE	1" = 60'
DATE	4/14/05
DESIGNED BY	MAC
DRAWN BY	MAC
CHECKED BY	
CONIFER TOWN CENTER WATER PLAN WELL COLLECTION LINES	
SHEET	01 OF 02
JOB NO.	14750-01